

Deronda Road, Herne Hill, SE24

2 bedroom flat - conversion for sale

£450,000

Share of Freehold

Property Details

A characterful two double bedroom flat on the first floor of an imposing Victorian property, perfectly positioned between Herne Hill and Tulse Hill, within close proximity to the greenery of Brockwell Park. This flat comprises a charming reception room, with a lovely bay window, which, along with the wooden flooring and high ceilings, adds character. The semi-open plan kitchen is functional and there is plenty of space for a dining table. Down the hallway, two double bedrooms share a modern bathroom. Tulse Hill station is within a five-minute walk, Herne Hill and West Dulwich are also close-by.

Features

- Victorian conversion
- Characterful features
- Bright and airy throughout
- Close to Brockwell Park
- Chain-free
- Share of freehold

Council tax band C

EPC rating C (71)



Deronda Road, Herne Hill, SE24



2 Bed flat

Approx internal area:

735 sqft 68 sqm

While we do try our very best, floor plans are produced as a guide only and we take no responsibility for the precise accuracy with which any property is represented

Deronda Road

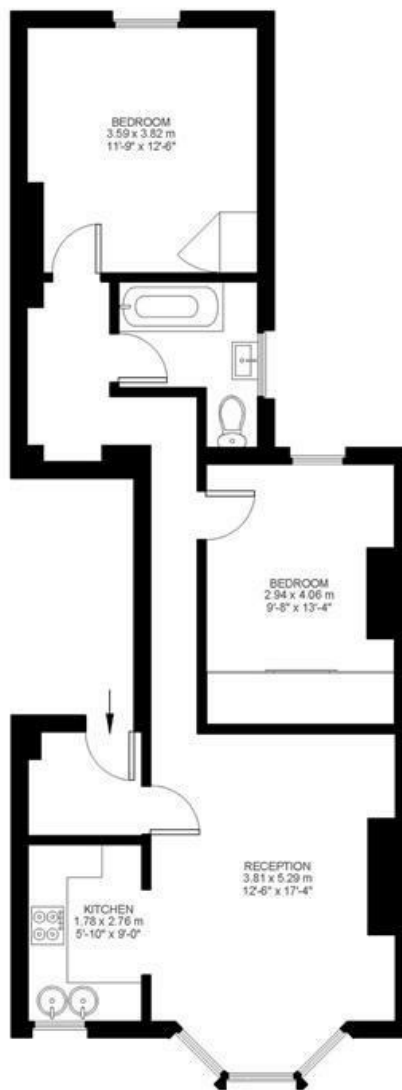

First Floor



Deronda Road, Herne Hill, SE24

